

THIS DRAWING IS UNPUBLISHED. RELEASED FOR PUBLICATION
 © COPYRIGHT - By - ALL RIGHTS RESERVED.

LOC		DIST		REVISIONS			
P	LTR	DESCRIPTION		DATE	DWN	APVD	
GP	00	F2	REVISED PER ECO-11-005033		26MAR11	RK	HMR

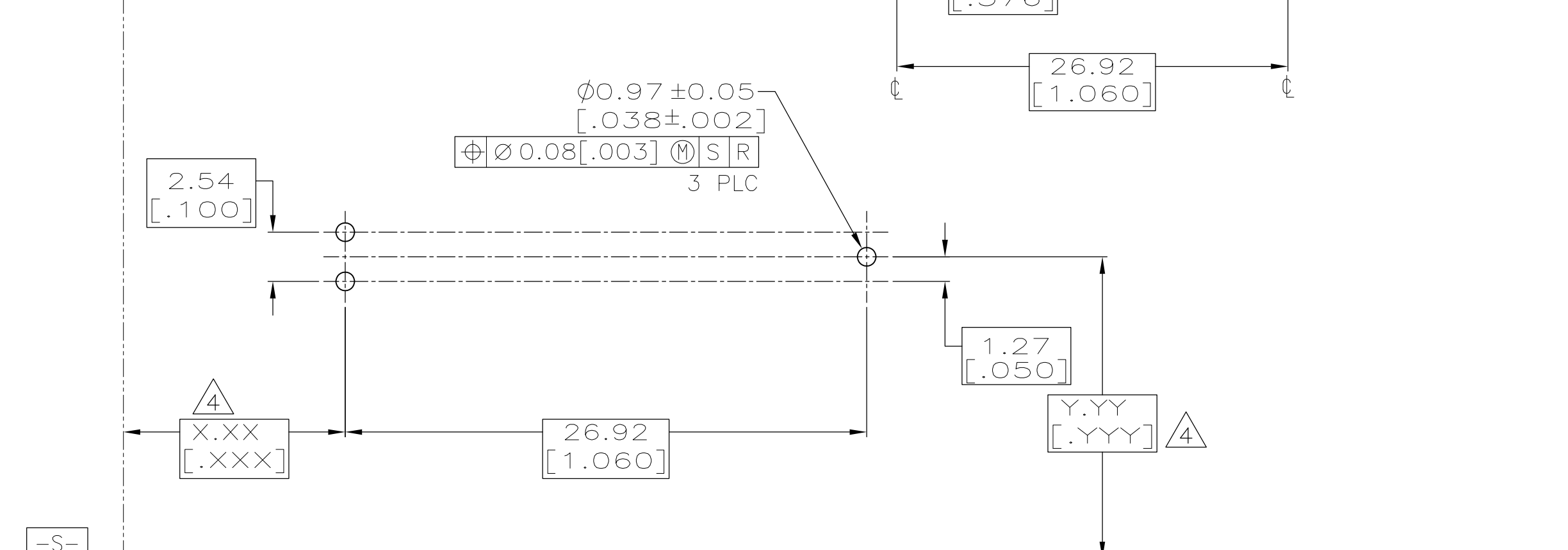
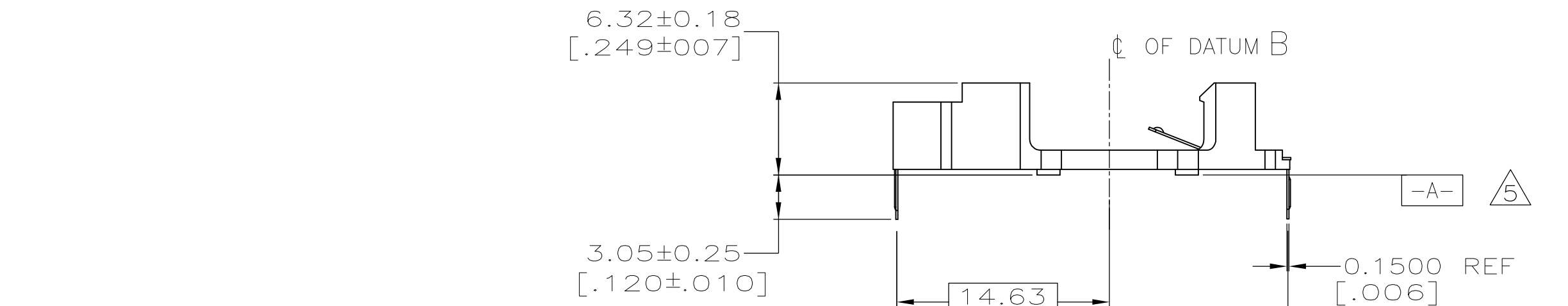
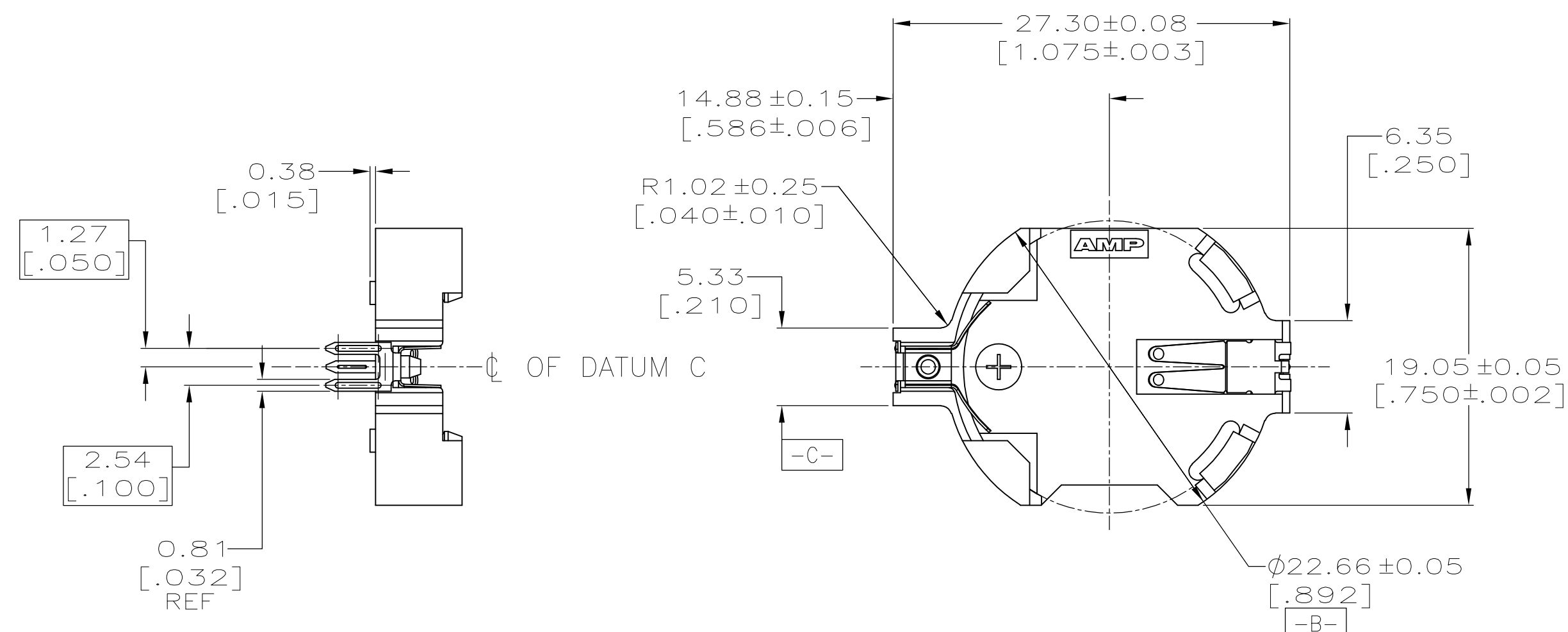

RECOMENDED PCB LAYOUT
 SCALE 4:1

- ① HOUSING MATERIAL: PBT, GLASS FILLED, UL-94V-0 FLAME CLASS RATING. COLOR: BLACK.
- ② CONTACTS: PHOSPHOR BRONZE, PRE TIN COATED 0.0015-0.0040 [0.00059-.000157] THICK.
- 3. CONNECTOR ACCEPTS BATTERY #CR2032.
- ④ DATUMS AND BASIC DIMENSIONS ESTABLISHED BY CUSTOMER.
- ⑤ REFERENCE BASE OF FOUR STANDOFFS FOR DATUM A.
- ⑥ CONTACTS: PHOSPHOR BRONZE, 0.03µm [1.2µMCH] MIN GOLD AT MATING INTERFACE AREA, 2-5µm [80-200µMCH] TIN AT SOLDER AREA, BOTH OVER 1.3µm [50µMCH] NICKEL MIN ON ENTIRE SURFACE.
- ⚠ OBSOLETE PARTS: OBSOLETE CIS STREAMLINING PER D.RENAUD/D.SINISI

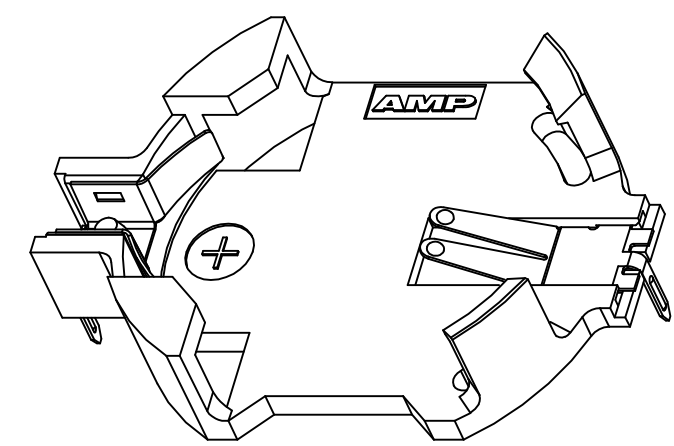
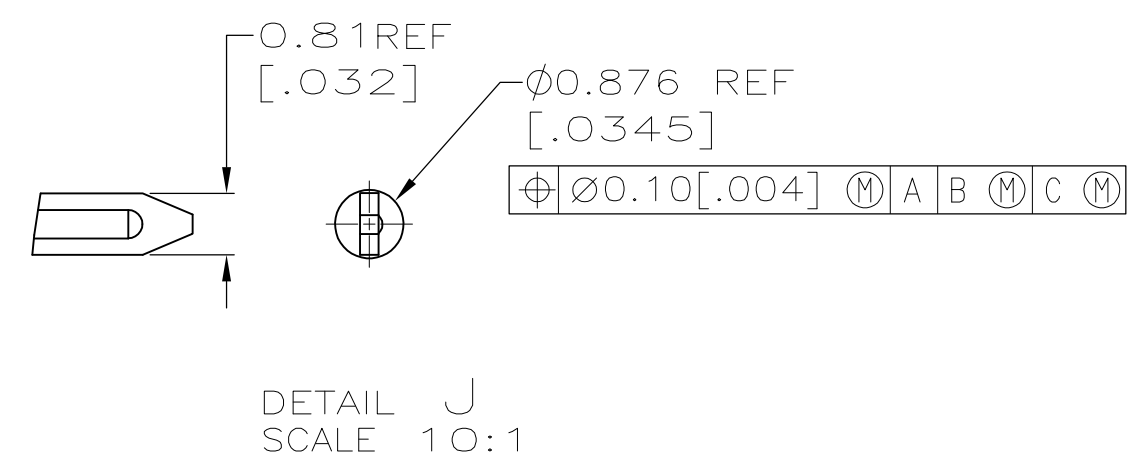
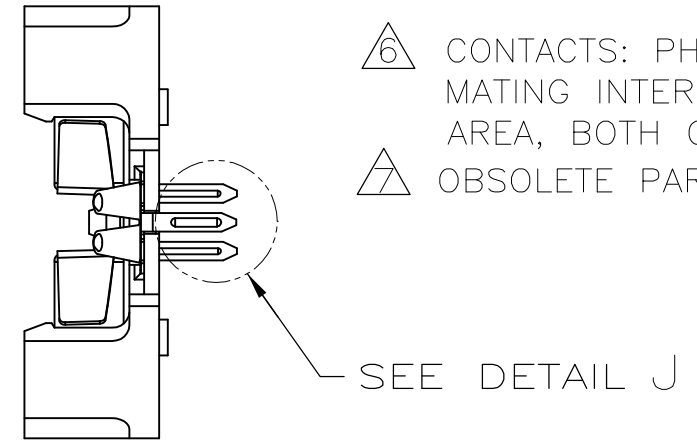

PACKAGING	PART NUMBER
— TRAY	120591-3-⑥
— TUBE	120591-2-②
TRAY	120591-1-②

THIS DRAWING IS A CONTROLLED DOCUMENT.		DWN J. REED 8/26/97	TE Connectivity	
DIMENSIONS: mm		CHK V. RUMINSKI 8/26/97		
TOLERANCES UNLESS OTHERWISE SPECIFIED:		APVD V. RUMINSKI 8/26/97	NAME	
0 PLC ± -	1 PLC ± -	PRODUCT SPEC 108-1691	ASSEMBLY, BATTERY CONNECTOR, TOP LOAD	
2 PLC ± 0.13 [.005]	3 PLC ± -	APPLICATION SPEC	SIZE A2	CAGE CODE 00779
4 PLC ± -	ANGLES ± 0° 30'	MATERIAL	DRAWING NO C=120591	RESTRICTED TO
FINISH		WEIGHT -	SCALE 3:1	SHEET 1 of 1
		CUSTOMER DRAWING	REV F2	