

140-2010 Snap Bushings

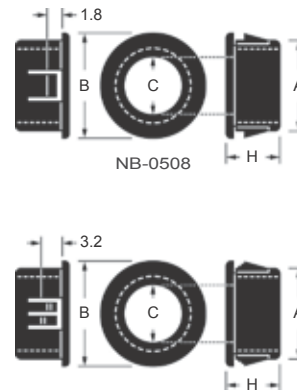

All AVC brand snap bushings are recognized under Components Program of Underwriters Laboratories Inc. except NB-0811 & 0813C, 1216C, 1419C, 1722C.

- Material : Nylon PA 66 (UL 94V-2).
- Color : Black. * Other colors are available upon request.
- These snap bushings convert raw edged holes in metal to smooth, neat insulated ones. They snap and lock into holes with fingertip pressure.
- As described in the diagram, these snap bushings can be applied to panel thicknesses from minimum 0.8 mm to maximum 3.2 mm.

Cat. No.	Mounting Hole		Dimensions				Std. Pkg.
	mm	Inch	A mm	B mm	C mm	H mm	pcs
NB - 0508	7.8	5/16 "	7.7	9.4	5.2	7.8	1000
	9.5	3/8 "	9.5	12	6.9	10.1	
	11	7/16 "	10.9	13.7	8.3	10.3	
	12.7	1/2 "	12.6	15.1	8.3	10.3	
	16	5/8 "	15.8	18	12.3	10.4	
	19	3/4 "	19	21.8	14.3	11.3	
NB - 1216	22.2	7/8 "	21.9	25.1	18.6	11.2	100
	25.5	1 "	25	28	19.3	11.2	
	30.5	1 3/16 "	29.8	34	24.3	11.6	
	12.7	1/2 "	12.7	14.1	8.7	10.1	
NB - 1216C	16	5/8 "	15.9	17.7	12.3	10.1	100
	19	3/4 "	19	20.3	14.2	10.3	
	22.2	7/8 "	22.2	23.5	17.5	10.3	
	22.2	7/8 "	22.2	23.5	17.5	10.3	

140-3010 Hole Plugs

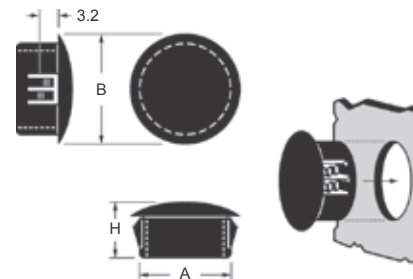

Maximum panel thickness for HP-08 is 1.8 mm and for other items is 3.2 mm.

- Material : Nylon PA 66 (UL 94V-2).
- Color : Black, Greys, White.
- Can be snapped into panel thickness from minimum 0.8 mm to maximum 3.2 mm.
- This hole plug will temporarily close the chassis holes quickly easily and at low cost for reuse whenever the holes are needed again and keep the chassis always clean and neat.

Sizes	Cat. No.				Mounting Hole		Dimensions			Std. Pkg.
	Black RAL 9005	Light Grey RAL 7035	Silver Grey RAL 7001	White RAL 9003	mm	Inch	A mm	B mm	H mm	pcs
	HP - 08	B	G	SG	W	7.8	5/16 "	7.8	9.5	7.7
HP - 09	B	G	SG	W	9.5	3/8 "	9.4	12	10.2	
HP - 13	B	G	SG	W	12.7	1/2 "	12.5	14.6	10.2	
HP - 16	B	G	SG	W	16	5/8 "	15.7	18.7	10.2	
HP - 19	B	G	SG	W	19	3/4 "	18.8	23.2	10.2	
HP - 22	B	G	SG	W	22	7/8 "	22	25.3	11.2	
HP - 25	B	G	SG	W	25.4	1 "	25	28	11.2	
HP - 30	B	G	SG	W	30.5	1 3/16 "	30.1	34.2	11.2	