

FR6 AA

Lithium Iron Disulfide
(Li-FeS₂) Batteries

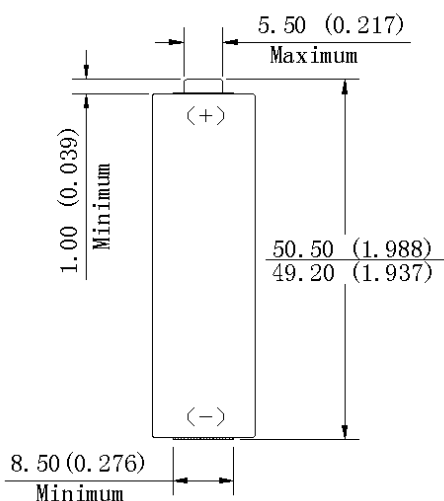
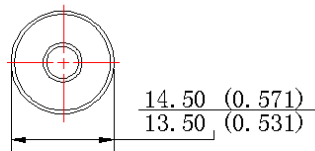

Nominal capacity (1000mA, 0.8V off)	>3000mAh
Nominal voltage	1.5V
Max. constant current	2000mA
Max. pulse current (2 sec on / 8 sec off)	3000mA
Operating temperature	-40~+60 C
Weight	15.6g
Typical Li content	0.98 g
Typical IR	≤150mΩ

Milliamp-Hours Capacity

constant current discharge to 0.9V at 21°C

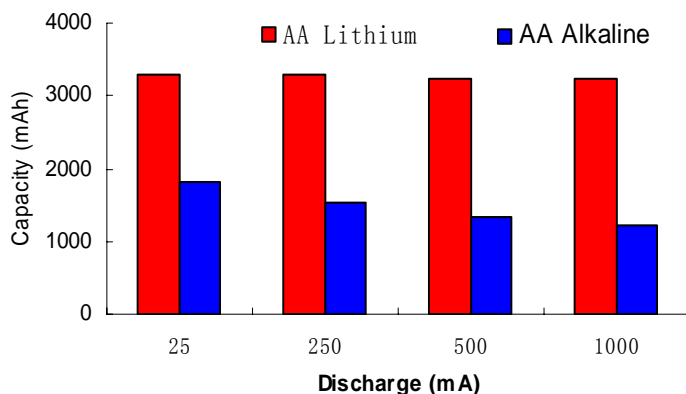

High Drain Performance

1000mA Continuous (20°C)

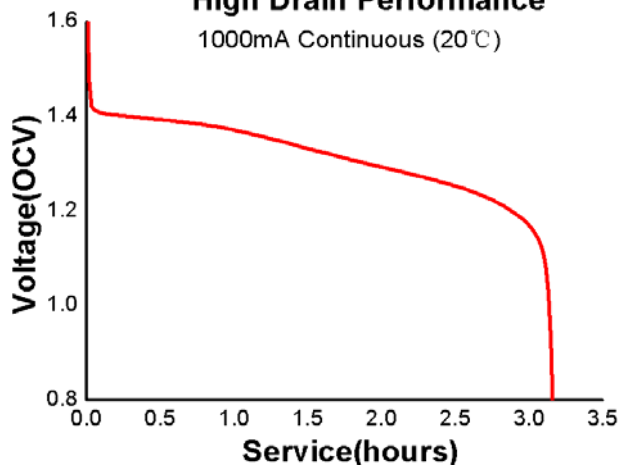

Constant Current Performance

Typical Characteristics to 1.0V at 20°C

