

Surface Mount LEDs

1208 Type 3.0mm(L) X 2.0mm(W) X 1.0mm(H)

IF=20mA Ta=25°C

Device No	Color		Wavelength (nm)		VF	Brightness (mcd)		View
	Emitter	Lens	λ_p	λ_d	Typical (V)	IV1	IV2	Angle 2 θ 1/2

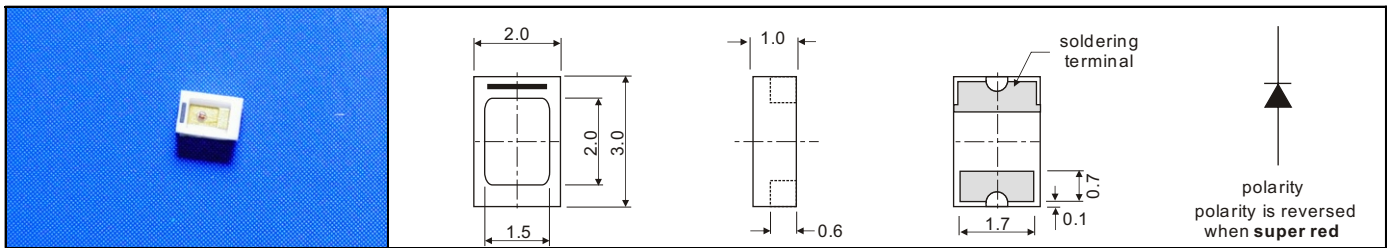

HCL-1402	hi-red	water clear	700	658	2.20	2.7	2.7	120.0
HCL-1403	yellow green	water clear	570	567	2.15	13.5	13.5	
HCL-1403DG	super yellow green	water clear	570	567	2.15	16.0	16.0	
HCL-1403AG	super pure green	water clear	523	525	3.50	150.0	150.0	
HCL-1404	yellow	water clear	589	585	2.10	7.5	7.5	
HCL-1404AY	super yellow	water clear	592	590	2.00	65.5	65.5	
HCL-1405	hi-eff red	water clear	625	618	2.05	13.5	13.5	
HCL-1405AO	super orange	water clear	620	615	2.00	65.0	65.0	
HCL-1406DR	super red	water clear	660	643	1.80	25.5	25.5	
HCL-1406CR	super red	water clear	660	643	1.80	37.5	37.5	
HCL-1406AR	super red	water clear	660	645	1.86	55.5	55.5	
HCL-1408AB	super blue	water clear	465	470	3.50	45.0	45.0	
HCL-1409AW	white	yellow clear	---	---	3.60	225.0	225.0	

IV1:Labsphere LED-1100 IV2:EXELTRON 2001.

Recommended Soldering Pattern:

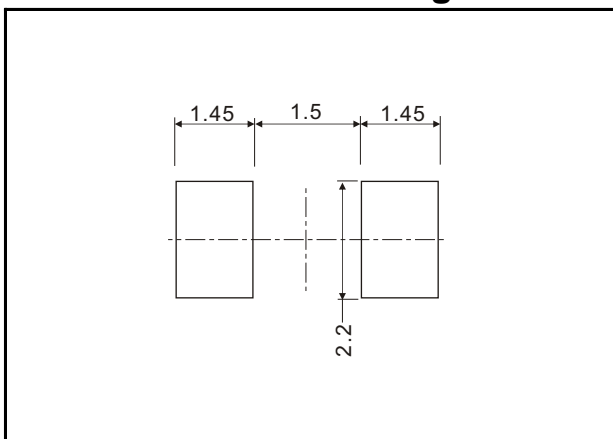

Tape Specifications:

(3,000pcs/Reel)

